

# AS-BUILT FOUNDATION PLAT OF SURVEY

## LOTS 22 AND 24 OF LAKE GENEVA CLUB

LOCATED IN PART OF NW 1/4 OF SECTION 8, TOWN 1 NORTH,  
RANGE 17 EAST, TOWN OF LINN, WALWORTH COUNTY, WISCONSIN

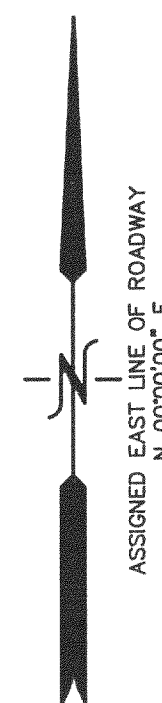

BENCH MARK  
FOUND "PK" NAIL  
IN PAVEMENT  
ELEV. = 895.80'

EXISTING RESIDENCE  
ENTRY ELEV. = 896.2'

LOT 20

S 88°45'20" E (82.72')  
82.65'

FOUND IRON PIPE STAKE  
N 51°11' W, 0.57' FROM  
IRON PIPE STAKE AT  
CORNER

POWER POLE

UTILITIES ALONG  
PROPERTY LINE

LOT 22

AS-BUILT  
FOUNDATION  
(FIELD LOCATED 03/03/06)

SEPTIC TANK

CHIMNEY

S 00°04'12" E  
100.14'  
(100.12')

LEGEND  
○ = FOUND IRON PIPE STAKE  
△ = FOUND "PK" NAIL IN PAVEMENT  
(XXX) = RECORDED AS

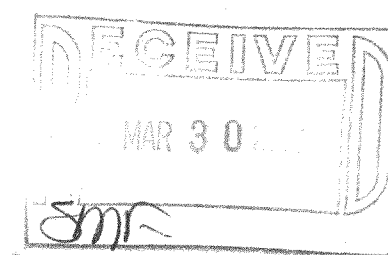

NOTE: COPIES OF THIS MAP TO WHICH THE FOLLOWING CERTIFICATE  
WILL APPLY SHOW THE SURVEYOR'S ORIGINAL SEAL AND SIGNATURE  
IN RED INK. COPIES BY ANY OTHER MEANS MAY HAVE ALTERATIONS  
WHICH DO NOT REPRESENT THE SURVEYOR'S WORK PRODUCT.

I HEREBY CERTIFY THAT THE ABOVE DESCRIBED PROPERTY HAS BEEN  
SURVEYED UNDER MY DIRECTION AND THAT THE ABOVE MAP IS A TRUE  
REPRESENTATION THEREOF AND SHOWS THE SIZE AND LOCATION OF  
THE PROPERTY AND ITS EXTERIOR BOUNDARIES. THIS SURVEY IS  
MADE FOR THE USE OF THE PRESENT OWNERS OF THE PROPERTY, AND  
ALSO THOSE WHO PURCHASE, MORTGAGE, OR GUARANTEE THE TITLE  
THERE TO WITHIN ONE YEAR FROM THE DATE HEREOF.

DATED: JANUARY 6, 2005

PETER S. GORDON R.L.S. 2101

WORK ORDERED BY -  
VERNE GILBERT  
F & S PROPERTIES  
P.O. BOX 85  
WALWORTH, WI 53184

FARRIS, HANSEN & ASSOCIATES, INC.  
ENGINEERING - ARCHITECTURE - SURVEYING  
7 RIDGWAY COURT P.O. BOX 437  
ELKHORN, WISCONSIN 53121  
OFFICE: (262) 723-2098 FAX: (262) 723-5886

REVISIONS  
03/03/2006  
TO SHOW SIZE  
AND LOCATION  
OF AS-BUILT  
FOUNDATION

PROJECT NO.  
6956  
DATE:  
01/06/06  
SHEET NO.  
1 OF 1

3/5/2006 x:\Projects\6956\Draw\AS-BUILT

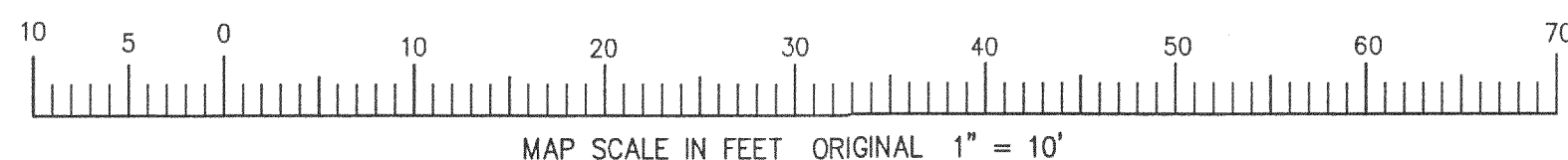

ILGC-22

117-2671